

AUBEPINE

3 Bedrooms - 2 Bathrooms – Sleeps 6 – Town Centre Location



Property Description

A spacious 3 bedroom apartment in the centre of Verbier. The location is very quiet offering views of the mountains and only a short walk to both the main ski station and all shops, restaurants & apres ski bars. Direct lift access for indoor garage parking.

Property Layout



Entrance hallway



Open plan Living area with fireplace



Open plan kitchen / dining area



South facing balcony



Double bedroom with en suite bathroom



Twin bedroom



Double bedroom



Separate shower room



Private garage parking

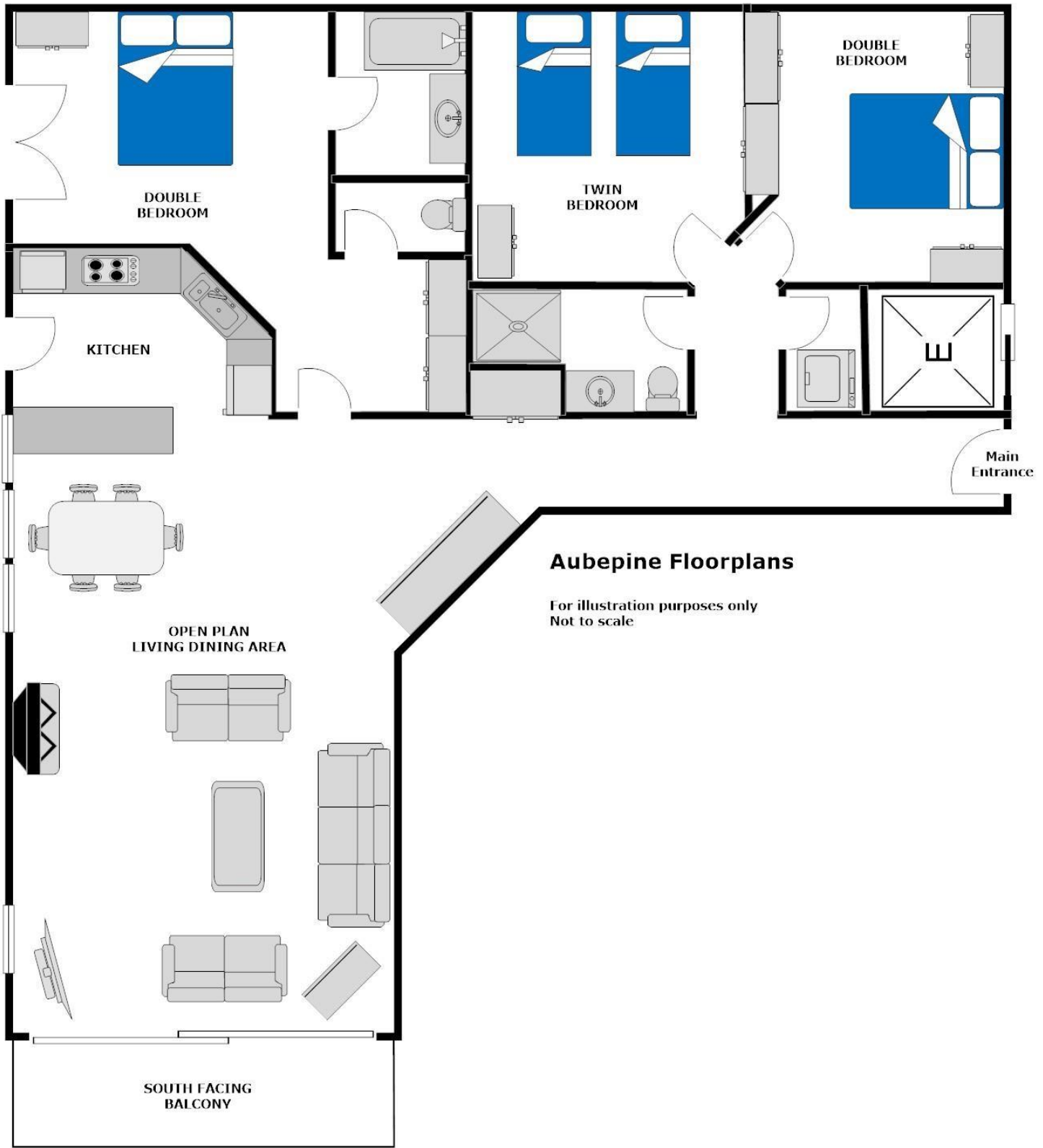

Aubepine Floorplans

For illustration purposes only
Not to scale











